



Thermocouple

TYPE TMI60

Measuring insert



- Measuring insert - Form TMMI - DIN 43735 is designed for Form B-TB, and also for mounting in B-head without protecting tube.
- The sensing element is with thermocouple according to DIN 43732. Tolerance class 1 or 2, IEC 584-2. Insulated measuring junction.
- The clamp socket is usually of plastic (200°C).
- Protective sheath of Inconel

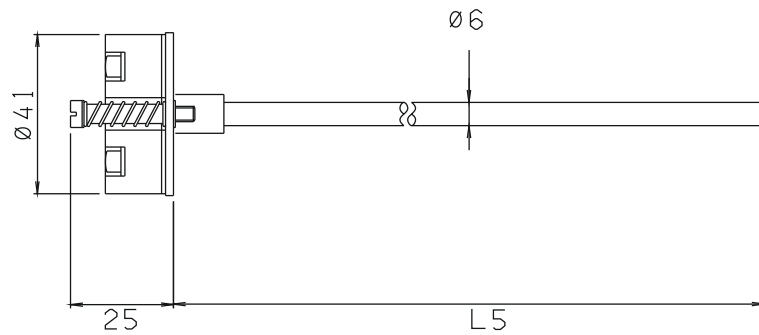

Ordering: See ordering form on back page



ORDERING FORM / THERMO COUPLE TYPE TMI60

Type TMI60

Insert length/L5/mm
Min. 50 mm -
max. 555 mm
Optional length

Number of thermocouples

1×TC
2×TC
Prep. for 2-wire transm.

				V2.2
1	2	1	2	
1	2	3	6	

Tolerance class

1 1
2 2

Thermoelement -

Type/working temperature

..... K - NiCr-Ni -40 / +800°C
..... J - Fe-CuNi -40 / +700°C
..... T - Cu-CuNi -40 / +300°C
..... N - NiCrSi-NiSi -40 / +800°C

Connection diagram:

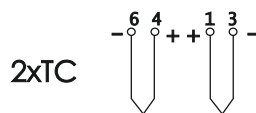
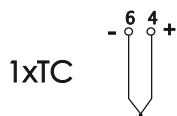

Head office:

Senmatic A/S
Industrivej 8, 5471 Søndersø, Denmark
Phone: +45 64 89 22 11
dk@senmatic.com - www.senmatic.com